

FEEDBACK

by **Service User and Carer Representatives**

to the **Lancashire Mental Health and Social Care Partnership Board (LPB)**

December 2009

Issue 12

In this issue -

- * **Mental Health Improvement Programme**
- * **Lancs Third Sector Consortium for Mental Health**
- * **Partnership and Strategic Commissioning Board updates**
- * **New Hospital update**

The LPB was established in 2005 to lead and support a programme of change within mental health services across Lancashire



Whyndyke Farm - Blackpool



Lancashire Care **NHS**
NHS Foundation Trust

New Build Project - The first of the new inpatient sites is to be built in the Fylde Coast. Whyndyke Farm is located on Preston New Road just off junction 4 of the M55.

For further information please call 01772 773519 or email mentalhealthmatters@lancashirecare.nhs.uk

Planning application nearer

The Trust is getting ready to submit an outline planning application for the development of the first of its new inpatient units at Whyndyke Farm in Blackpool.

This is a brief summary of information provided by Lancashire Care NHS Foundation Trust. Full details may be found on the www.lancashirecare.nhs.uk/mentalhealthmatters website.

The outline planning application is likely to take place later this year. If it is successful this will complete the sale of the land to the Trust and the process of applying for full planning permission can begin. If everything goes smoothly, planning approval should be finalised in April 2010 and building work should start the following October.

Work to secure the Burnley Bridge site for the East Lancashire unit is also progressing well. Later this Autumn the Trust should have agreed with the landowners the details for the land purchase for the new unit.

Over the summer, staff and service users were asked to give their views on what the layout of the new units should be like. The architects came up with five options to illustrate how ward areas could be arranged.

The images illustrate the preferred option. It is based upon a hospital street which opens onto garden spaces between the wards. All the wards face towards the East to provide a nice view, and all ward gardens are positioned to ensure that they will receive sunlight at some point in the day.

The central therapy areas are also located near gardens.

All visitor and patient accommodation is on the ground floor level. The upper floor would be used for offices, administration and education areas. Pictured are plans for functional and dementia wards. These are not the final designs and are indicative to show the work that is in progress to date.

If you have any queries or comments about the New Build Project please contact mentalhealthmatters as above.



Organic ward plan

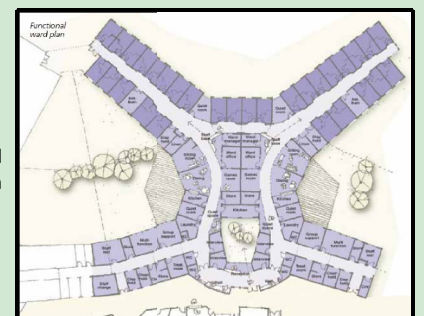

Functional ward plan

Lancashire Mental Health and Social Care Partnership Board

Made up of representation from Local Authorities, NHS Trusts, Third Sector, Service Users & Carers



Working together to improve mental health

Lancashire Mental Health and Social Care Partnership Board - UPDATE

On **Tuesday, 15th December 2009**, all organisational and service user and carer members of the Lancashire Mental Health and Social Care Partnership Board will meet for the first time since their last full board meeting in March.

In June, Richard Jones (LPB co-chair & Exec. Director of Adult Social Services for Lancashire County Council) asked service user and carer members to consider how they would like to see the Partnership Board continue, in respect of:-

Who should be LPB members?

Which issues should the board focus on?

The frequency of board meetings.

The length and structure of meetings?

What additional support do service user and carer members need in their volunteer representative roles?

As a result, the **9 service user and carer members** have continued to meet regularly to discuss these issues and to plan a way forward for the Board.

It has been agreed with both Partnership Board co-chairs Richard Jones and Judith Griffin (Chief Executive, NHS Blackburn with Darwen) that members of the Board will include senior executives and one chairman from Lancashire NHS Trusts and Local Authorities including:-

- NHS Blackburn with Darwen
- NHS Blackpool
- NHS Central Lancashire
- NHS East Lancashire
- NHS North Lancashire
- Lancashire Care NHS F.Trust
- Lancashire County Council
- Blackburn with Darwen B. Council
- Blackpool Council

The third sector will also continue to have representation from the Chair of the **Lancashire Third Sector Consortium for Mental Health**.

Member invitations have also been

sent to senior executives at the **Department of Work and Pensions/ Jobcentreplus (North West)** and **Lancashire Constabulary**. With acceptances received, we are pleased to advise that Partnership Board membership will now include employment services and the police.

Partnership Board meetings will be held quarterly rather than every two months, but in a very different format. Splitting into two parts; the first being a formal meeting, the second as a workshop with members working together in small groups to discuss one issue only.

The first issue to be discussed in December will be 'outcomes'. Looking at what service users and carers want to see and expect to happen from having used services, and how these views need to be taken forward by commissioners (people who fund services), to ensure they have an influence on how services are run.

Feedback from each quarterly Partnership Board meeting will be included in future editions of this newsletter to keep you updated on any strategic developments. Information will be posted on the LPB website as soon as it is available.



Chorley & South Ribble

"ART – WORKS"

Art on prescription

Shaw Trust Awarded Big Lottery Funding

The project will support people who are recovering from mental health issues to achieve mainstream work. Working from local community centres to provide ease of access to the service, providing opportunities for volunteers to support others in their learning and to learn new skills whilst exploring ideas and aspirations for employment.

The service will be based on **art focused activities** enabling people to gain confidence and provide integration whilst learning new skills. This will lead to support from employment focused staff who will provide guidance to access further learning, voluntary work, and paid employment.

For further details, please contact Shaw Trust Press Manager Samantha Jobber on **01225 716300** or 07595 214649. Website: www.shaw-trust.org.uk



Moving On are dedicated to providing practical help and support to adults who have been unemployed and on long term benefits. They provide co-ordinated carer pathways that will prepare people to move on, to take part in education, training, voluntary work or employment.

Moving On is delivered in local community centres where clients feel comfortable and secure, enabling people to make lifestyle changes and improve their well-being by increasing confidence and willingness to participate in activities, focusing on long term lifestyle changes, not quick fixes.

Referral to the service is made through social workers or community mental health teams.

For more information about projects in Preston and Skelmersdale, please contact **Moving On:-**



Tel: **01695 726644** Mobile: 07879 036196
Email: info@movingonlancashire.co.uk



Lancashire Care **NHS**
NHS Foundation Trust

MENTAL HEALTH HELPLINE



For the people of Lancashire

Opening Hours

Monday to Friday

7.00pm-11.00pm

(Including Christmas and New Year)

Saturday & Sunday

12 Noon - 12 Midnight

26th Dec 7pm-11pm

&

27th Dec 7pm-11pm

FREEPHONE HELPLINE

0500 639000

www.lancs-mentalhealthhelpline.nhs.uk



The North West has the highest level of hospital admissions for depression and anxiety at 55% and 29% above the national average respectively.

The rate for hospital admission for schizophrenia is also the highest nationally, at 39% higher than the national average.

In September 2007 **NHS Northwest** established a **Regional Commission for Mental Health** to take stock of the current state of mental health and mental health services in the North West.

The Commission was asked to make recommendations on how to achieve a step change in the level and performance of both mental health and mental health services and did so in its report;



A better future in mind published in October 2008 setting out 12 recommendations for change.

The report set out proposals for a **Mental Health Improvement Programme** including underpinning principles, governance, interface with other development initiatives and an initial outline of possible programme content. This was developed following discussions with key NHS and Social Care stakeholders including **representatives of users and carers**.

The proposals include the need to strengthen the voice of service users and carers, a greater focus on preventing mental health problems, more sophisticated commissioning of services and more investment in staff training and development.

The **Mental Health Improvement Programme** began work on an 18 month programme on 1st April 2009 to address the proposals. The MHIP is working in partnership with existing improvement programmes and initiatives in the region including the Government Office of the NW, the NW Development Agency the NHS NW Improvement and Leadership Academies, workforce commissioning and the SHA Quality Board. For more information about the work of the MHIP take a look at the Mental Health News link below.

As part of the programme to strengthen the voice of users and carers MHIP appointed (through a tender process) joint partners Rethink and the University of Central Lancashire (UCLan) to set up a network which will act as the basis for user, carer and public engagement across the North West region.

Collective Voice North West's ambition is to re-address the balance of power through creating a platform for users, carers and the public to engage in wider policy influence and health system changes

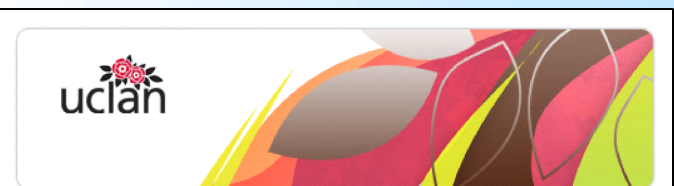

Collective Voice North West, a regional network to develop service user, carer and public engagement.

rethink

From the 1st June 2009 a partnership between Rethink and The University of Central Lancashire (UCLan) has been formed to develop this network and provide a way for people to have their say in the improvement of mental health services in the North West. **This is part of the Mental Health Improvement Programme (MHIP).**

The key principles underpinning the work of MHIP are fairness and inclusiveness. They include a commitment to the effective engagement of people who use services for all ages, their carers and others with a non-professional interest in mental health.

Future events:-

21st January 2010	Chester
21st April 2010	Cumbria
6th July 2010	Manchester/Liverpool
9th October 2010	Preston

The Mental Health Improvement Programme, NHS North West, Room 463, Gateway House, Piccadilly South, Manchester M60 7LP.

Email: mhipinformation@northwest.nhs.uk

Website: <http://www.northwest.nhs.uk/whatwedo/mentalhealthinthenorthwest>

To subscribe to **MENTAL HEALTH NEWS** please email: subscribemhipnewsnorthwest@northwest.nhs.uk



The **Lancashire Third Sector Consortium for Mental Health (LTSC)** is a consortium of charitable and non profit making organisations who work together to provide mental health services for the people of Lancashire.

The LTSC are pleased to advise they will be providing independent support to Partnership Board service user and carer members as from 28th October 2009, to assist them in their volunteer representative roles.

The LTSC is chaired by Grainne Cuerden (Rethink) and co-chaired by Peter Green (Richmond Fellowship).

If you would like further information about the Consortium please contact Katharine Wykes (Third Sector Development Officer) on 07884 295399 or email - ltscmentalhealth@googlegmail.com.

Lancashire Strategic Commissioning Board for Mental Health & Wellbeing

On the 11th September, Maureen (LPB East Lancs SU Rep) attended her first quarterly meeting as SU member of the Strategic Commissioning Board. Maureen met with Directors of Lancashire's 5 primary care trusts and 3 local authorities and took part in discussions around commissioning (funding) of Lancashire wide services. The meeting was chaired by Judith Griffin (Chief Exec, NHS Blackburn with Darwen). Maureen gives an account of her experience.

"I can't recall how many people were there or how senior they were, maybe that's because the people there didn't hide behind their titles! All were respectful and polite. This was the first time I'd met most people and I was a bit nervous. Judith Griffin and Rebecca Davis (Network Director for MH Commissioning) tried hard to put me at ease and people did seem genuinely pleased to have service user representation.

Obviously I didn't understand all that was going on and in the main listened. When I made contributions I felt I was heard and this was taken into account within the decisions that were made. Judith was chair and asked on several occasions if I wanted/needed to ask or say something.

As a person who does suffer from enduring mental distress, I have found it very important to ensure that I choose forums/working groups that are progressive and honourable in their intentions in relation to service user involvement. Being mindful of this, I got good vibes from this group of people. As such, I hope that my continued attendance will turn service user views into positive working practices at the coalface of service delivery and serve to keep these very busy, senior people, grounded in terms of our daily reality.

It was also worth noting that staff representation on this Board (as with LPB) consists of members who represent all three Local Authorities and the Health Care Trusts. This is important because it gives us another opportunity to question/challenge issues of equity of services across health and social care physical boundaries within Lancashire.

*Commissioning is without question "the powerhouse" of our services, service user and carer involvement on this Board is vital to ensure that services commissioned are meaningful. This is a great opportunity to influence our service and I would be very honoured to receive your views to progress my role as your service user representative on this Board." **Maureen***

Majorie - LPB Carer rep for Central & West Lancs will be joining the Strategic Commissioning Board as carer representative from December 2009.



LPB Service User and Carer Representatives

Angela

Carer - Fylde Coast

Brian

Service User - Central Lancs

Ian

Carer - North Lancs

Marjorie

Carer - Central & West Lancs

Maureen

Service User - East Lancs

Phil

Service User - Fylde Coast

Rod

Service User - North Lancs

Valerie

Carer - East Lancs

Waheda

Carer - Lancashire BME

If you would like to make contact with your area representative or register your details to be kept informed of our current work, please contact

The LPB Team, Guide Business Centre, School Lane, Blackburn BB1 2QH - Tel:01254 282229 Fax: 01254 282233

Email: lancashirementalhealth@bwdpct.nhs.uk - your details will be held in the strictest confidence

Disclaimer - Every care has been taken in the compilation and publication of the content of this newsletter. However, the LPB will not be held responsible for any loss, damage or inconvenience caused as a result of any inaccuracy or error within these pages, and is not responsible for the content or services provided by any third parties included. The information contained in this newsletter is for general information only and does not constitute advice on personal health or any other matter.